

## Adaptability to Enhanced Security



## AD@PTEC Plus

AdapTec Plus combines power supply and door access controller features in a compact metal casing for an encrypted and secure I/O function, enhancing door access control functionalities and easing installation processes. The AdapTec Plus is an exceptional FingerTec accessory in a small package!



### Enhanced Security with Encrypted Signals

It supports FingerTec encrypted 26-bit Wiegand communication output; providing enhanced security level for extra protection.



### Power Up Terminals & Door Lock Systems

A single AdapTec Plus can provide power simultaneously to a maximum 2 units of FingerTec terminals and 2 sets of door lock accessories such as EM Lock and drop bolt in one single system installation.



### Prolonged Life Span of Hardware

With data encryption, the life span of the terminals could be prolonged without the risk of short circuiting when using AdapTec Plus.



### Control IN/OUT Terminals At An Entrance

AdapTec Plus is a perfect choice for an IN/OUT installation, where a door is controlled both, at the entrance and the exit.



### Support Rechargeable Backup Battery

Connects well to any 12V rechargeable backup battery, providing power to ensure protection of access during any events of power failure.



### Alert Emergency with Siren

Compatible with an NC siren type with a maximum of 0.5A load for emergency event e.g if the terminal is being illegally dismantled.



### Seamless Integration with FingerTec Terminals

Mix and match the FingerTec terminals via AdapTec Plus for a cost effective access control system suitable for small and medium sized offices.



### Choose DIY Metal Casing for Cleaner Installation

Store an AdapTec Plus and a backup battery in an exclusive FingerTec DIY metal casing, providing a cleaner installation.

## WEB LINK

 **Installation Guide**  
<http://info.fingertec.com/adaptecplus-1>

 **Video Guide**  
<http://info.fingertec.com/adaptecplus-2>

## LAYOUT PLAN

### System Communication

for illustration only

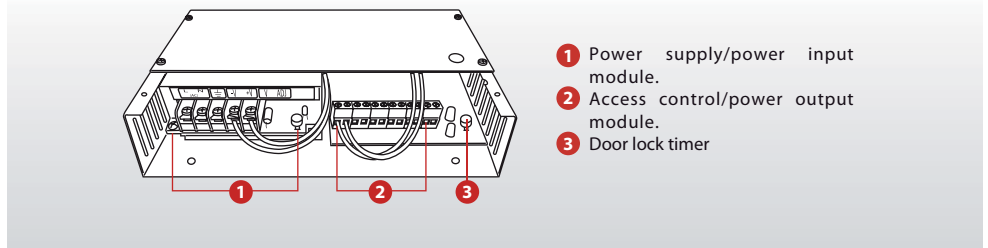

### Installation Diagram

for illustration only

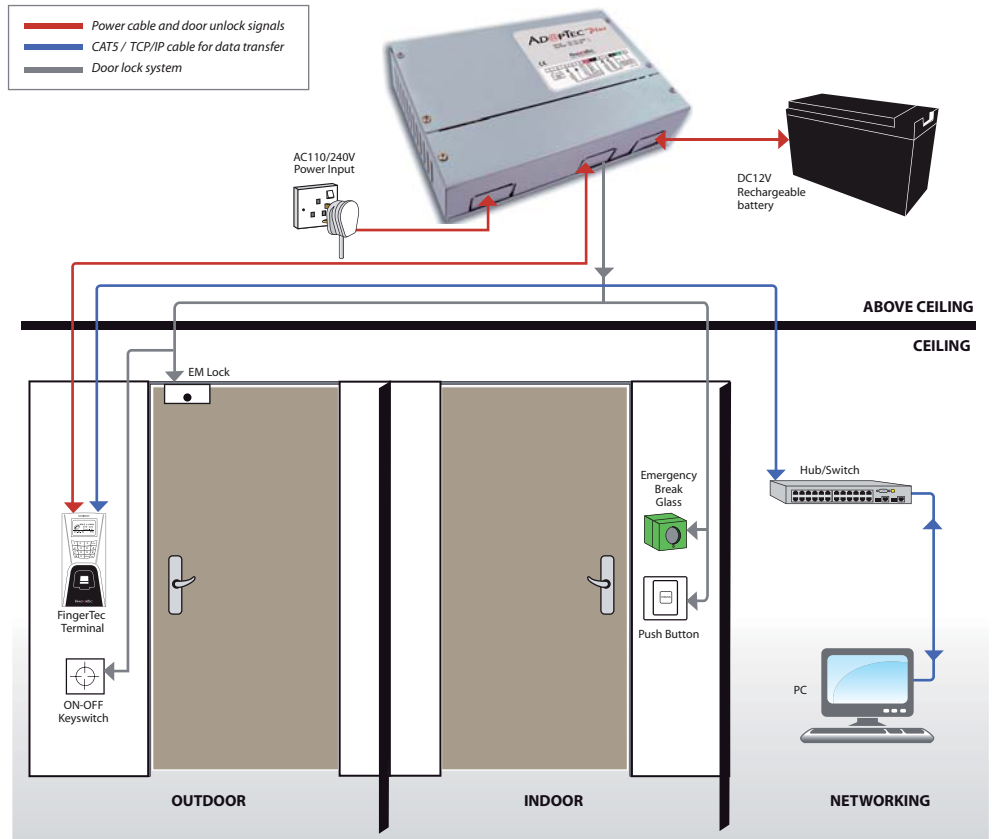

## SPECIFICATIONS

<b>MODEL</b>	AdapTec Plus
<b>PRODUCT DIMENSION (L X W X H), mm</b>	198 x 45 X 131
<b>WEIGHT</b>	1.1 kg
<b>CPU</b>	8 MHz 16-bit microprocessor
<b>POWER INPUT</b>	AC 110 ~ 240V (universal input)
<b>POWER OUTPUT</b>	DC12V 3A - Supports up to • 2 x FingerTec access control terminals • 2 x electrical energized locks
<b>BACKUP POWER SYSTEM</b>	UPS or DC 12V rechargeable backup battery
<b>INPUT SIGNAL</b>	FingerTec encrypted Wiegand signal
<b>OUTPUT SIGNAL</b>	2 x FORM C Relay • 1 x 0.5A siren (max) • 1 x DC12V 3A EM output (max)
<b>DOOR LOCK</b>	• Electromagnetic locks • Door strike • Drop bolt/Dead bolt
<b>OPERATING TEMPERATURE</b>	0°C to 55°C
<b>HUMIDITY</b>	10% to 90% RH (non-condensing)



### Packaging

Dimension (mm) : 138(L) x 59(W) x 211(H)  
 Weight : 1.2 kg

Authorized Reseller:



**FINGERTEC**  
[www.fingertec.com](http://www.fingertec.com)

© 2011 FingerTec Worldwide Sdn. Bhd. All rights reserved.